

MAGICSHINE®



ALLTY 1500S
USER MANUAL

WARNING

To prevent inadvertent switching on, please keep the light unit in lockout mode before transport or storage.



IN THE BOX



ALLTY 1500S



Handlebar mount



3mm hex key



MJ-6508 remote control (incl. strap)



Silicone strap



USB-C charging cable

Display 0%-100% remaining battery level according to 5 equal parts.

Charging: The level corresponding to the percentage of the current battery will keep flashing, and the OLED screen will display the dynamic charging icon and the power percentage.



Fully charged: The OLED screen displays a static 100% power icon for 3 minutes, and if you click the switch on the light unit after 3 minutes, the screen will display the power percentage for 2 seconds.

* The light can work normally during charging. However, to extend the battery life, please do not use the light when charging.

WORK STATUS DISPLAY



Currently selected lighting mode

- APP customized mode
- ▣ Smart mode
- Constant mode
- ≡ Flash mode

Remaining battery percentage

- 100%–80%
- 79%–60%
- 59%–40%
- 39%–20%
- 19%–0%

Available runtime Lumen



CONNECT WITH THE APP

APP CONNECTION :

1. iOS users scan the QR code of the manual, and Android users go to the MAGICSHINE website "www.magicshine.com" (SUPPORT>User Manual>App Download for Android) to download the APP using your smartphone.
2. Turn on the Bluetooth of your smartphone and open the APP, click "Add New Devices" and find "M1-B3". Click "Add", then click "Connect the device" .

APP SETTINGS :

1. Click "Add" at the bottom to enter the "Device Settings" interface.
 2. Customize "Constant mode," "SOS," "Slow flash," and "Quick flash," as well as their corresponding brightness.
 3. Up to 20 customized modes are supported.
- *When you delete all customized modes in the APP, the light will return to the factory default mode.

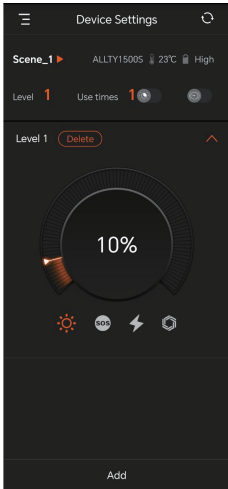

Light sensor button



Vibration sensor button



Brightness adjustment slider



Constant mode



SOS



Slow flash



Quick flash

HOW TO INSTALL

INSTALL ON HANDLEBAR

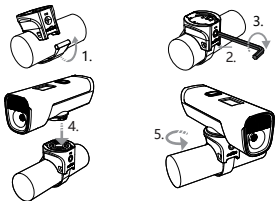

REMOVE THE BATTERY

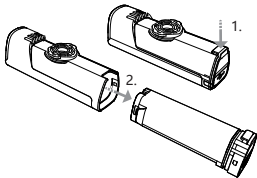

HEADLIGHT BUTTON INSTRUCTIONS

LOCKOUT/UNLOCK:

When the light is off, press and hold the switch for 3 seconds to enter lockout mode. In lockout mode, click the switch to display the LOCKOUT icon for 3 seconds. To unlock the light, you can press and hold the switch again for 3 seconds or charge the light.

ON/OFF:

Press and hold the switch to turn the light on/off, the default output is the last mode when turned off.

ADJUST BRIGHTNESS:

When the light is on, click the switch to change the brightness level. The output brightness will cycle through LOW→MEDIUM→HIGH. When in flash mode, it will cycle through SLOW FLASH and QUICK FLASH.

CHANGE MODE:

Double click the switch to change between constant mode and flash mode.

SMART MODE:

During the daytime, the DRL is always on and the main light will be off. At nighttime, the DRL and the main light will light up together. (The smart mode is off by default, activate it through the APP)

*In the factory default mode, when the light sensor is on, the OLED screen will display the smart mode icon.

SLEEP MODE:

The light will enter sleep mode after 5 minutes of inaction and be automatically activated on any vibrations. (The sleep mode is off by default, activate it through the APP)

LOW POWER MODE:

When the battery power is lower than 10%, the light will automatically turn to LOW mode and cannot be adjusted. Charge the light as soon as possible.

REMOTE CONTROL INSTRUCTIONS

PAIRING:

Turn on the light, press and hold the "○" "□" buttons on the remote for about 10 seconds until the indicator alternately flashes blue to enter pairing mode. Then, close the remote to the light button until the "⇌" icon shows on the OLED screen for 2 seconds and the remote's indicator is constantly blue for 2 seconds, confirming a successful pairing.

REMOTE CONTROL OPERATION:

ON/OFF: Press and hold the "○"/"□" button for 1 second

ADJUST BRIGHTNESS: Click the "○" button

CHANGE MODE: Double click the "○" button

FULL OUTPUT MODE (1500LM): Click the "□" button to go into Full Output Mode and click the "○"/"□" button to return to the previous mode.

CHECK BATTERY LEVEL: Click the "○"/"□" button

*In lockout mode, press the "○"/"□" button, the LOCKOUT icon will be displayed on the OLED screen, and the light will not light up.

OUTPUT / RUNTIME

CONSTANT MODE	LOW	300LM	9.5H
	MEDIUM	750LM	4H
	HIGH	1500LM	3.5H
FLASH MODE	SLOW FLASH	500~0LM	10.5H
	QUICK FLASH	500~0LM	31H

* All data are measured in accordance with ANSI/NEMA FL 1-2009. The test was conducted at a temperature of 25°C and a wind speed of 25 km/h. The runtime may vary depending on external temperature and ventilation conditions, and these deviations may affect the result of testing.

BATTERY INDICATOR

Click the switch on the light unit to display the remaining battery percentage for 2 seconds. Standard charging time approx. 3 hrs (5V, 2A)



EN WARRANTY

The Magicshine lighting system is warrantied for 24 months from the date of purchase.

If you register the lighting system on the Magicshine website you will receive a bonus 6 month warranty. Battery packs and AC adapters have a 6 month warranty, however, there is no bonus warranty available.

The warranty is limited to defects in material and workmanship on the lighting system itself, the battery pack and the AC adapter.

The warranty is only valid if the affected parts have not been tampered with and there is no intentional damage. Please keep your proof of purchase in a safe place. Proof of purchase must be presented in the event of any claim. Please contact the specialist retailer from whom you purchased the device for complaint or warranty claim.

Alternatively, you can send your complaint or claim directly to Magicshine at

Tel: (+86) 755-295 536 69

Fax: (+86)755-275 897 77

E-mail: support@magicshine.com (order from Magicshine.com online store)

service@magicshine.com(order from other sales channels)

In the event of a justified warranty claim and delivery of a replacement device, you will only be entitled to a model available when replacing. The manufacturer retains the right to make technical modifications.

Customer Information

Name: _____ Tel: _____

E-Mail: _____

Address: _____ Zip: _____

Product Information

Company Name / Website of the Seller: _____

Product Name: _____ Model No.: _____

Date of Purchase: _____ Contact: _____

Tel: _____ E-mail: _____

Address: _____ Zip: _____

Product Serial Number

Note: **Register on Website to Gain 6 Months Extra Warranty Rights.**

- Proof of purchase is required when obtaining warranty service.
- DO NOT return suspected defective parts directly to MAGICSHINE or the seller.
- Defective parts must only be sent to the seller you purchased your product from. Please contact them beforehand to confirm acceptance.