

MJ-900S USER MANUAL

ACCESSORY/STRUCTURE

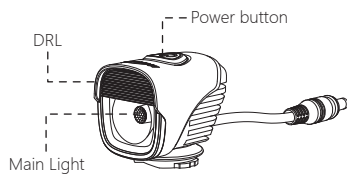

HOW TO INSTALL

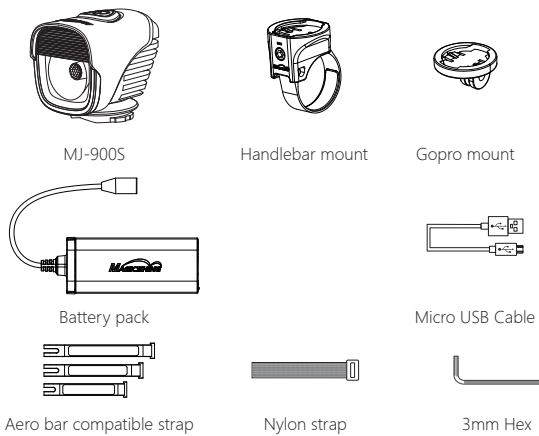
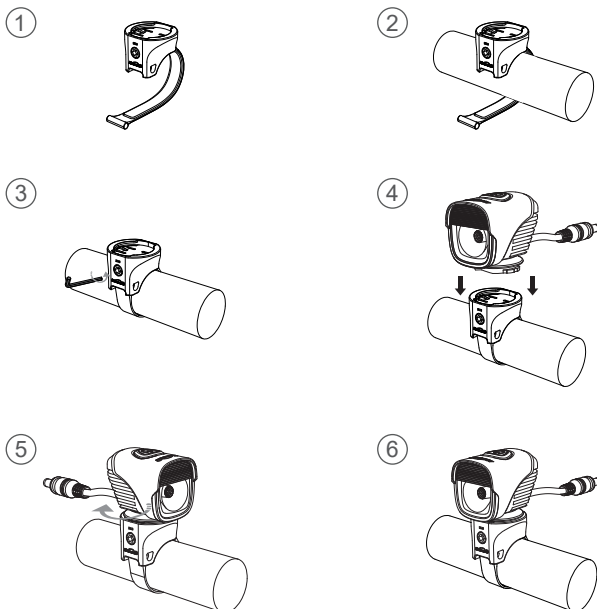

HOW TO INSTALL BATTERY PACK

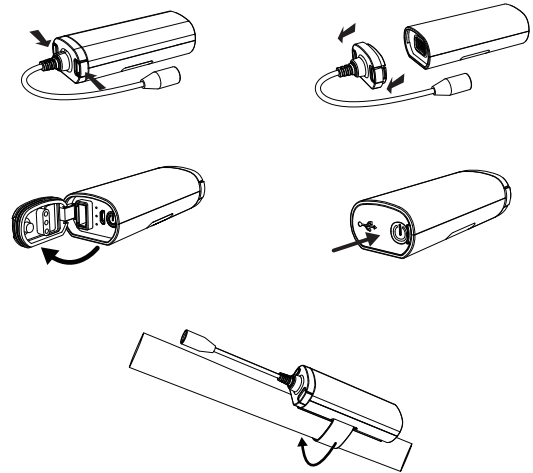

BATTERY INDICATOR

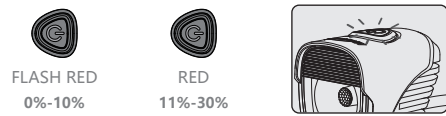

HOW TO RECHARGE

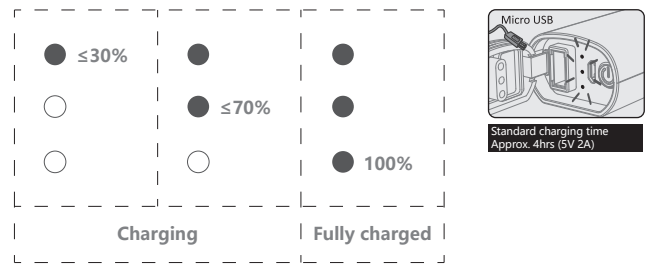

SWITCHING THE LIGHTING MODE

Hold 1s power button to turn on/off

Modes Switch:

From bicycle light mode to E-bike light mode:

Long press power button for 8 seconds until it flashes.

From E-bike light mode to bicycle light mode:

Long press power button for 8 seconds until it lights constantly.

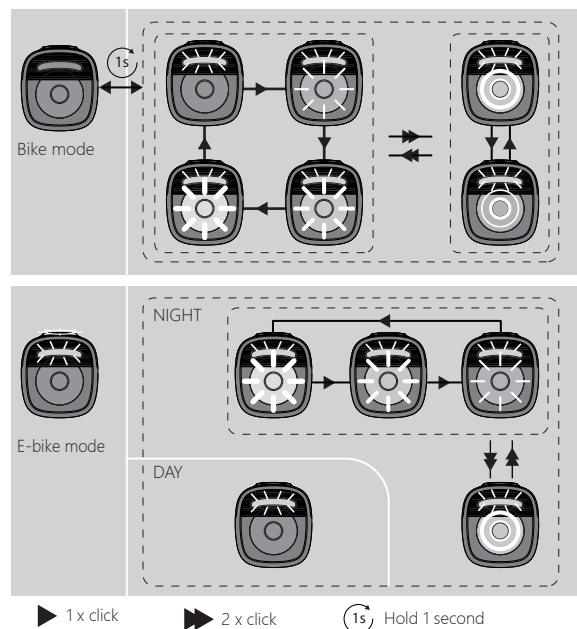

LUMENS/RUN TIME

Bike mode	CONSTANT	DRL	LOW	MID	HIGH
	LUMENS	15	500	1000	1500
	h:min	25:00	05:00	02:12	01:30
	FLASH	FLASH 1	FLASH 2	/	/
	LUMENS	0-1000	0-500	/	/
	h:min	05:00	09:30	/	/
E-bike mode	NIGHT	HIGH	MID	LOW	FLASH
	LUMENS	1500	1000	500	0-1000
	DAY	DRL	/	/	/
	LUMENS	15	/	/	/

The data is tested in laboratory conditions, and the actual performance can change according to the environment.

OPTIONAL PARTS



Helmet mount

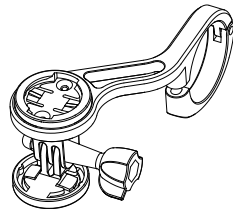

TTA front mount

*Adaptable accessories (sold separately)

WARNING



EN WARRANTY

The Magicshine lighting system is warranted for 24 months from the date of purchase.

If you register the lighting system on the Magicshine website you will receive a bonus 6 month warranty.

Battery packs and AC adapters have a 6 month warranty, however, there is no bonus warranty available.

The warranty is limited to defects in material and workmanship on the lighting system itself, the battery pack and the AC adapter.

The warranty is only valid if the affected parts have not been tampered with and there is no intentional damage. Please keep your proof of purchase in a safe place. Proof of purchase must be presented in the event of any claim. Please contact the specialist retailer from whom you purchased the device for complaint or warranty claim.

Alternatively, you can send your complaint or claim directly to Magicshine at

Tel: (+86) 755-295 536 69

Fax: (+86)755-275 897 77

E-mail: support@magicshine.com (order from Magicshine.com online store)

service@magicshine.com (order from other sales channels)

In the event of a justified warranty claim and delivery of a replacement device, you will only be entitled to a model available when replacing. The manufacturer retains the right to make technical modifications.

ANSI FL 1 STANDARD

